



# RE/MAX

## PROPERTY HUB



### **12 Meadow Halt, Newton Abbot, TQ12 6FA**

**Asking price £240,000**

RE/MAX are delighted to bring to the market this stunning 2-bedroom end of terraced home, located in the popular residential area of Ogwell, which has been beautifully upgraded by the current owners to an exceptional standard. Offering modern living and contemporary finishes throughout, this property is ready to move into and is being sold CHAIN FREE.

The ground floor comprises a bespoke fitted staircase, a modern fitted kitchen, open plan living room/dining room. Upstairs there are two double bedrooms and a modern fitted bathroom.

Externally, the property benefits from an allocated parking space, an open-plan front garden, and a vast private rear garden with a peaceful woodland backdrop.

This property is perfect for first-time buyers or as an investment opportunity, offering both comfort and convenience in a highly desirable location.



# Floor Plan

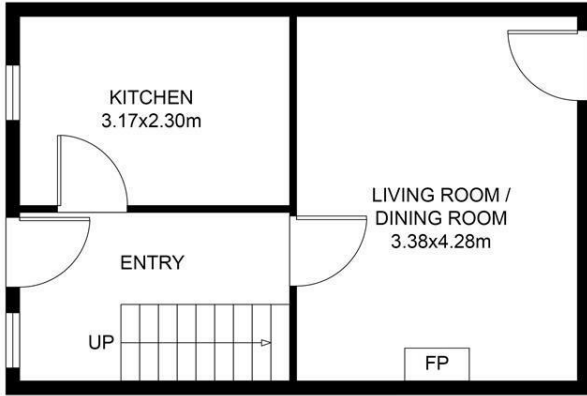

GROUND FLOOR PLAN

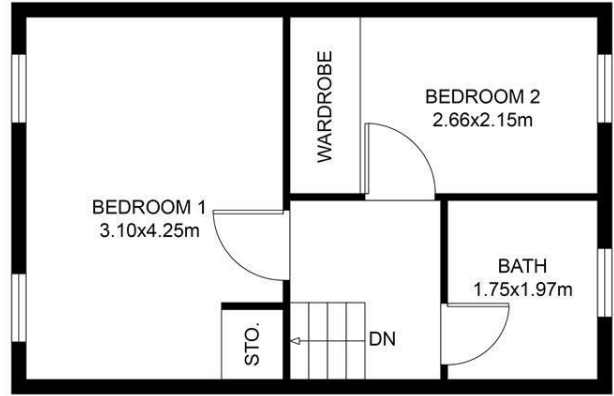

FIRST FLOOR PLAN

This floor plan including furniture, fixture measurements and dimensions are approximate and for illustrative purposes only. RE/MAX gives no guarantee, warranty or representation as to the accuracy and layout. All enquiries must be directed to the agent, vendor or party representing this floor plan.

# Area Map

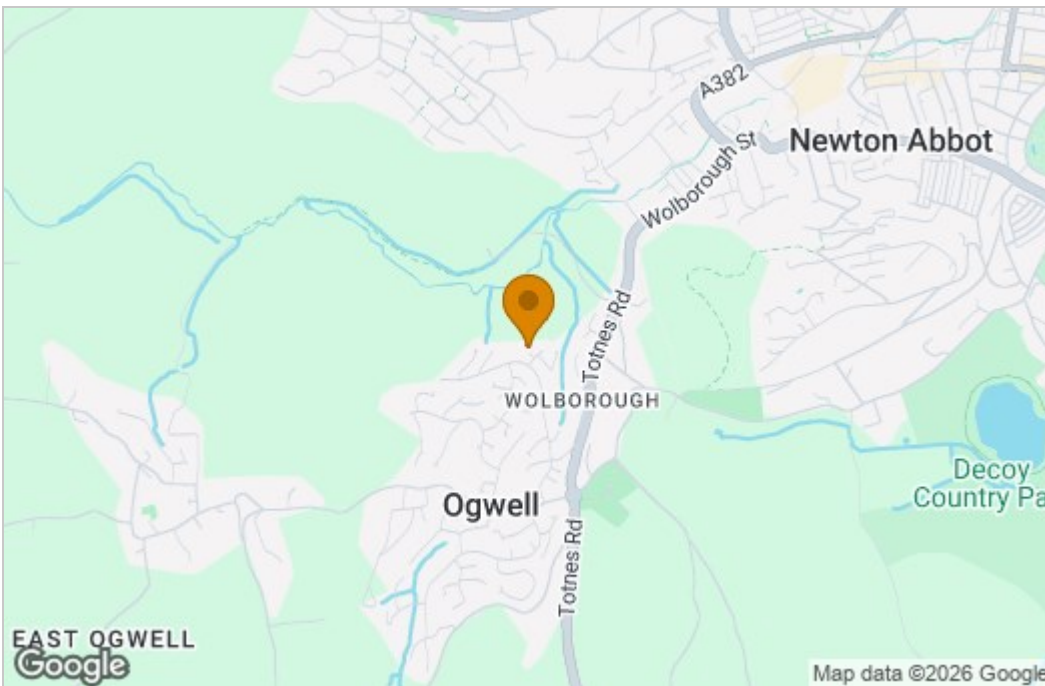

# Energy Efficiency Graph

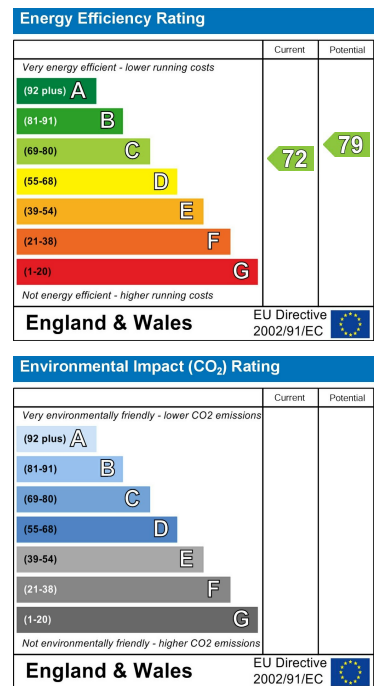

These particulars, whilst believed to be accurate are set out as a general outline only for guidance and do not constitute any part of an offer or contract. Intending purchasers should not rely on them as statements of representation of fact, but must satisfy themselves by inspection or otherwise as to their accuracy. No person in this firm's employment has the authority to make or give any representation or warranty in respect of the property.